

CAROLYN AND KEM GARDNER COMMONS BUILDING MAP

FIRST FLOOR

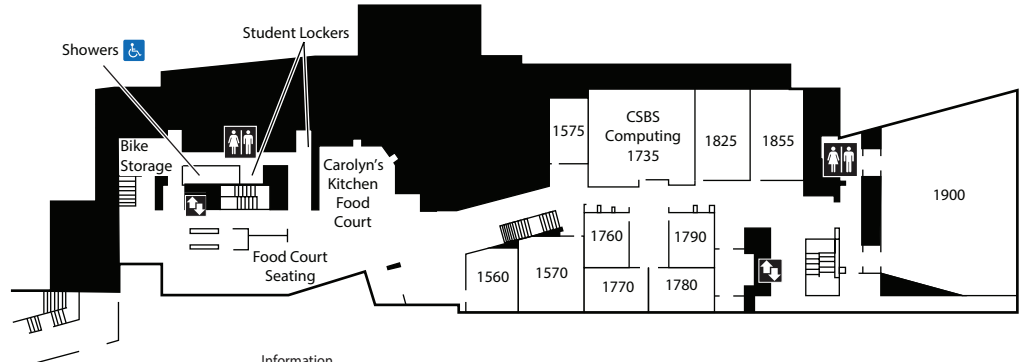

SECOND FLOOR

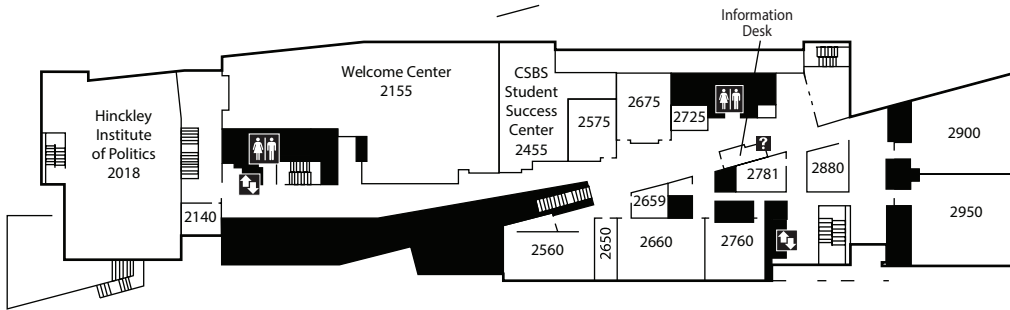

THIRD FLOOR

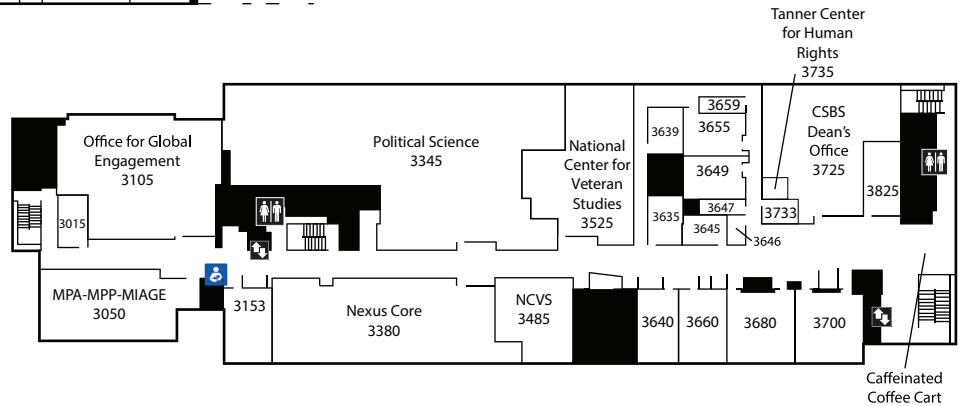

FOURTH FLOOR

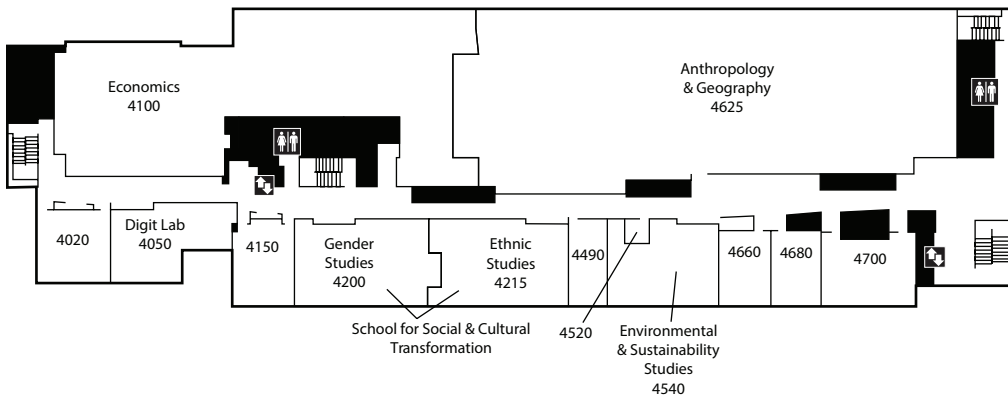

FIFTH FLOOR

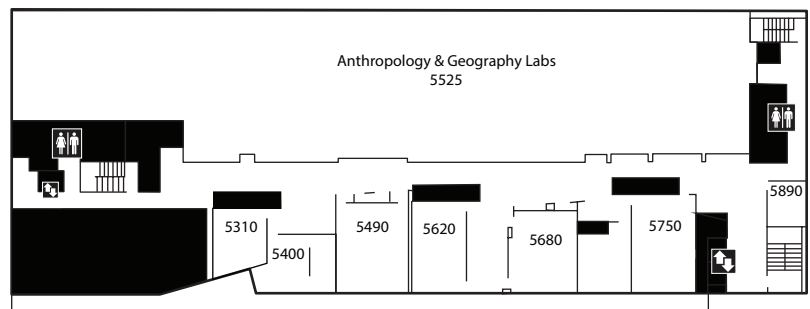



Carolyn and Kem
GARDNER COMMONS
THE UNIVERSITY OF UTAH

Fifth Floor

| | | | |
|-------------------------------|------|-----------|------|
| Classroom | 5310 | Classroom | 5620 |
| Conference Room | 5400 | Classroom | 5680 |
| Classroom | 5490 | Classroom | 5750 |
| Anthropology & Geography Labs | 5525 | Classroom | 5890 |

Fourth Floor

| | | | |
|----------------|------|--|------|
| Classroom | 4020 | Conference Room | 4490 |
| Digit Lab | 4050 | Counseling Office | 4520 |
| Economics | 4100 | Environmental & Sustainability Studies | 4540 |
| Classroom | 4150 | Anthropology & Geography | 4625 |
| Gender Studies | 4200 | Classroom | 4660 |
| Ethnic Studies | 4215 | Classroom | 4680 |
| | | Classroom | 4700 |

Third Floor

| | | | |
|------------------------------|------|--------------------------------|------|
| MPA-MPP-MIAGE | 3050 | Classroom | 3680 |
| Classroom | 3015 | Classroom | 3700 |
| Office for Global Engagement | 3105 | Payment Office | 3646 |
| Classroom | 3153 | CSBS Dean's Office | 3725 |
| Political Science | 3345 | Office of Research Admin | 3733 |
| Nexus Core | 3380 | Tanner Center for Human Rights | 3735 |
| NCVS | 3525 | Conference / Seminar | 3825 |
| Classroom | 3640 | Caffeinated Coffee Cart | |
| Classroom | 3660 | | |

Second Floor

| | | | |
|--------------------------------|------|-----------|------|
| Hinckley Institute of Politics | 2018 | Classroom | 2675 |
| Classroom | 2140 | Classroom | 2725 |
| Welcome Center | 2155 | Classroom | 2760 |
| Student Success Center | 2455 | Classroom | 2781 |
| Classroom | 2560 | Classroom | 2880 |
| Classroom | 2575 | Classroom | 2900 |
| Classroom | 2660 | Classroom | 2950 |
| Classroom | 2659 | | |

First Floor

| | | | |
|-----------|------|------------------------------|------|
| Classroom | 1560 | Classroom | 1790 |
| Classroom | 1570 | CSBS Computing | 1735 |
| Classroom | 1575 | Classroom Lab | 1825 |
| Classroom | 1760 | Classroom Lab | 1855 |
| Classroom | 1770 | Classroom | 1900 |
| Classroom | 1780 | Carolyn's Kitchen Food Court | |